

PRELIMINARY SECTIONS
NCRSP - PARCEL 49
 MAJOR PROJECT PERMIT - STAGE 1
 ROSEVILLE, CA
 SHEET 1 OF 1

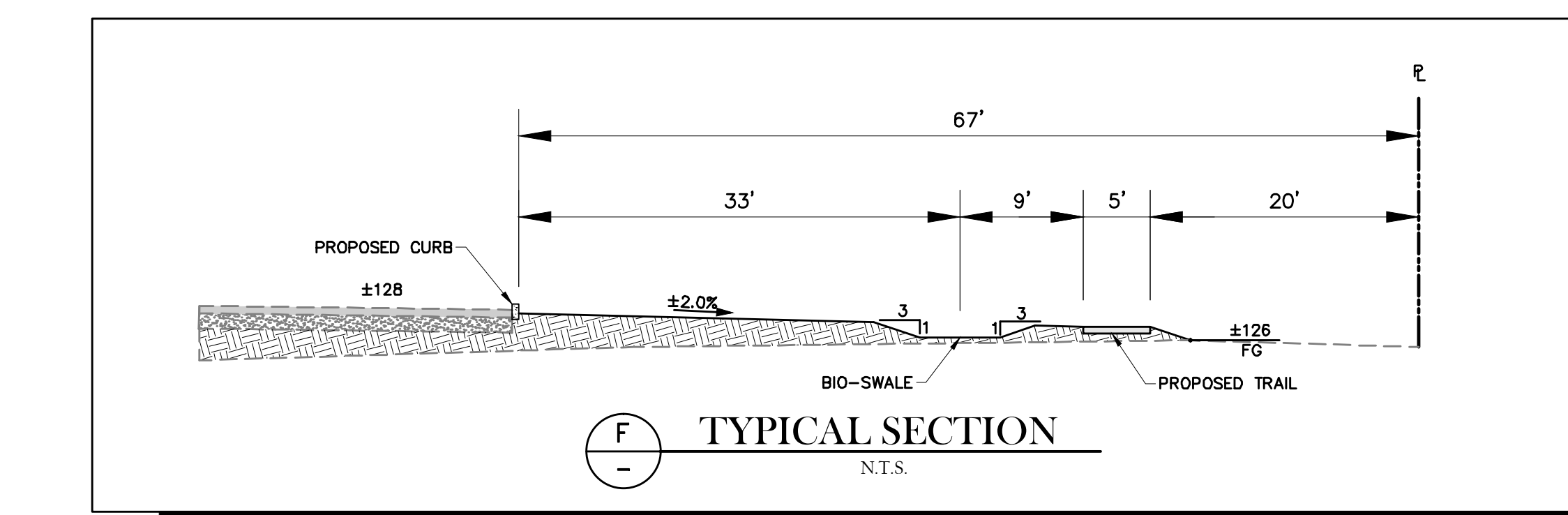
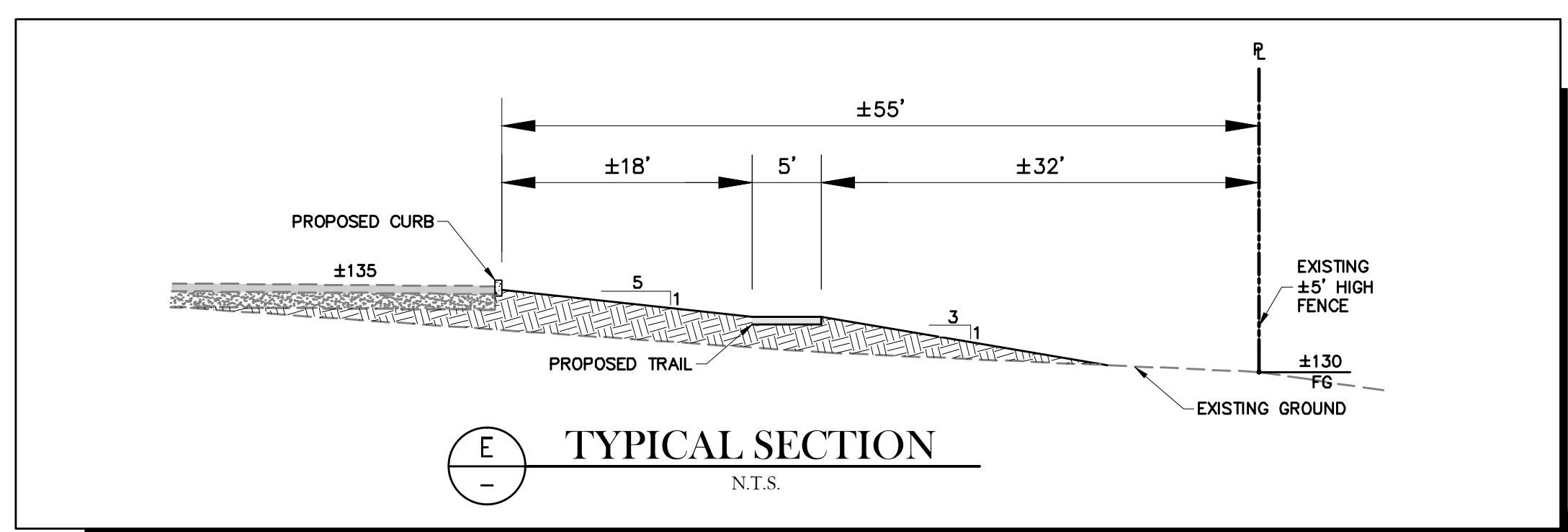
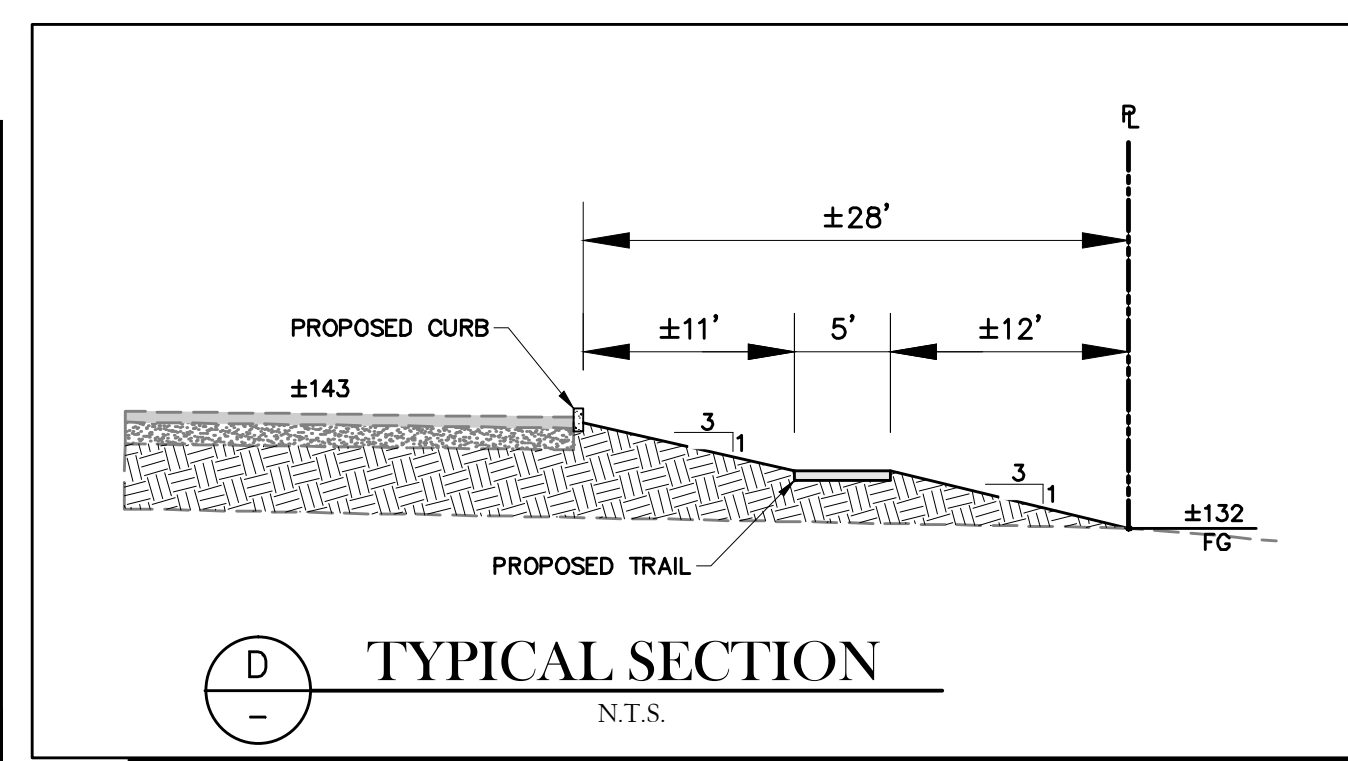
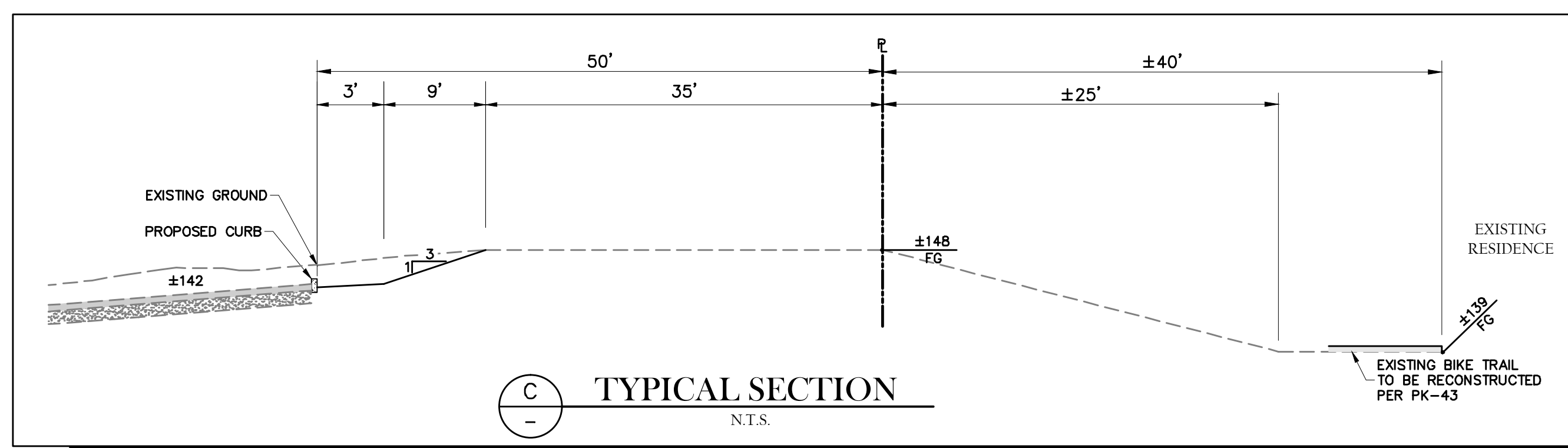
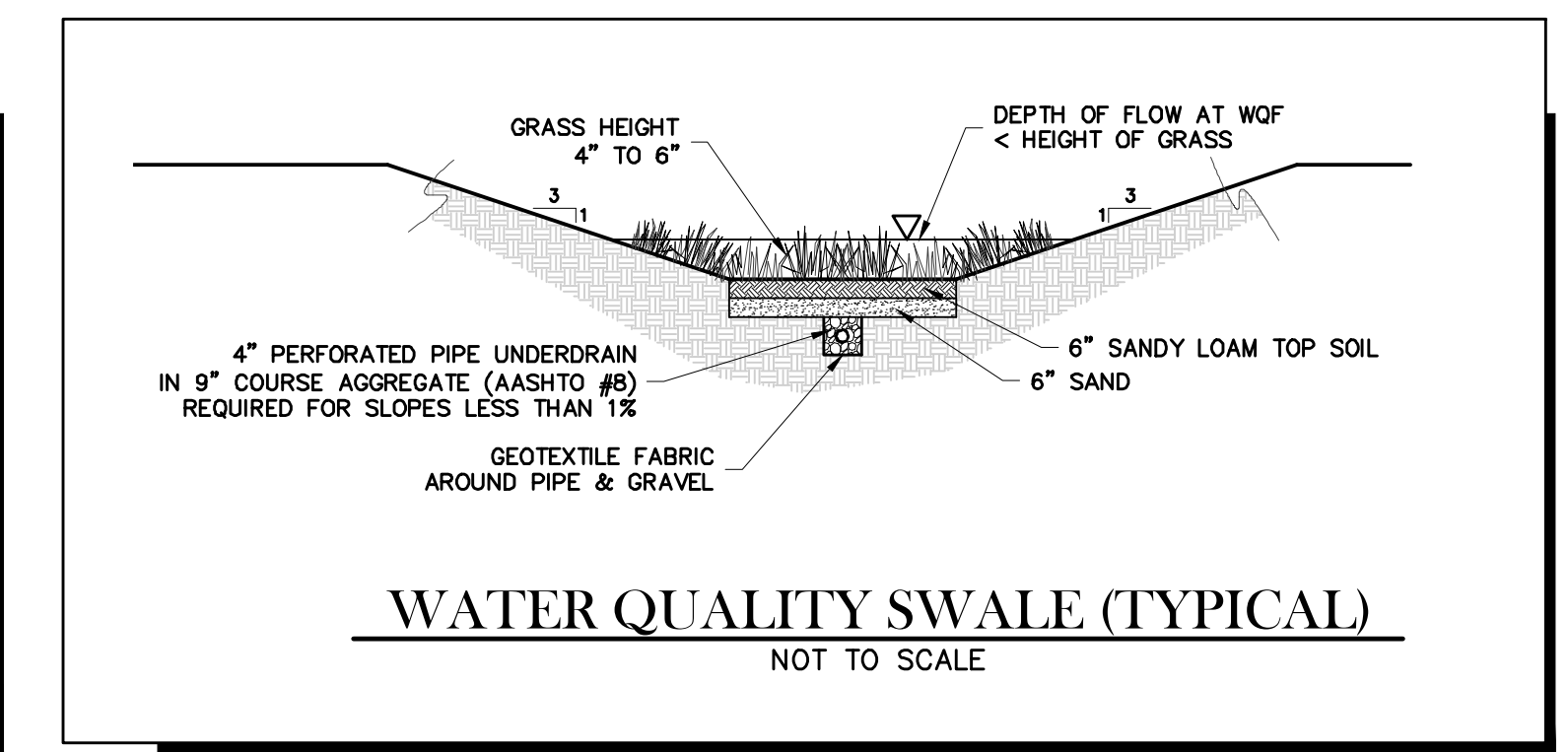
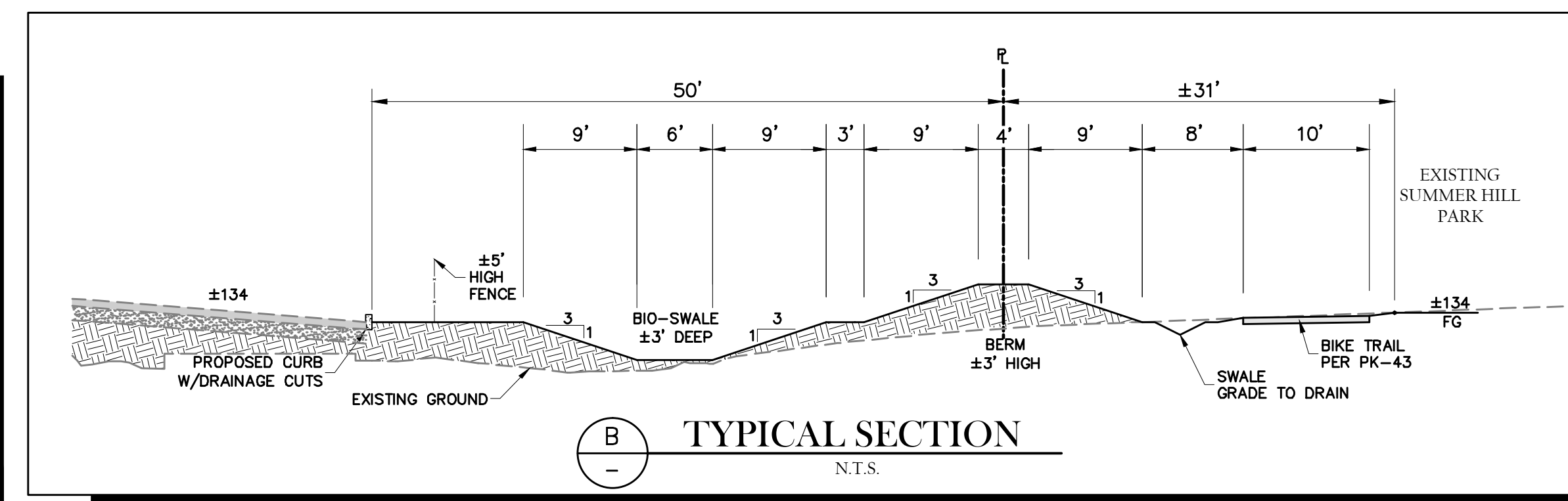
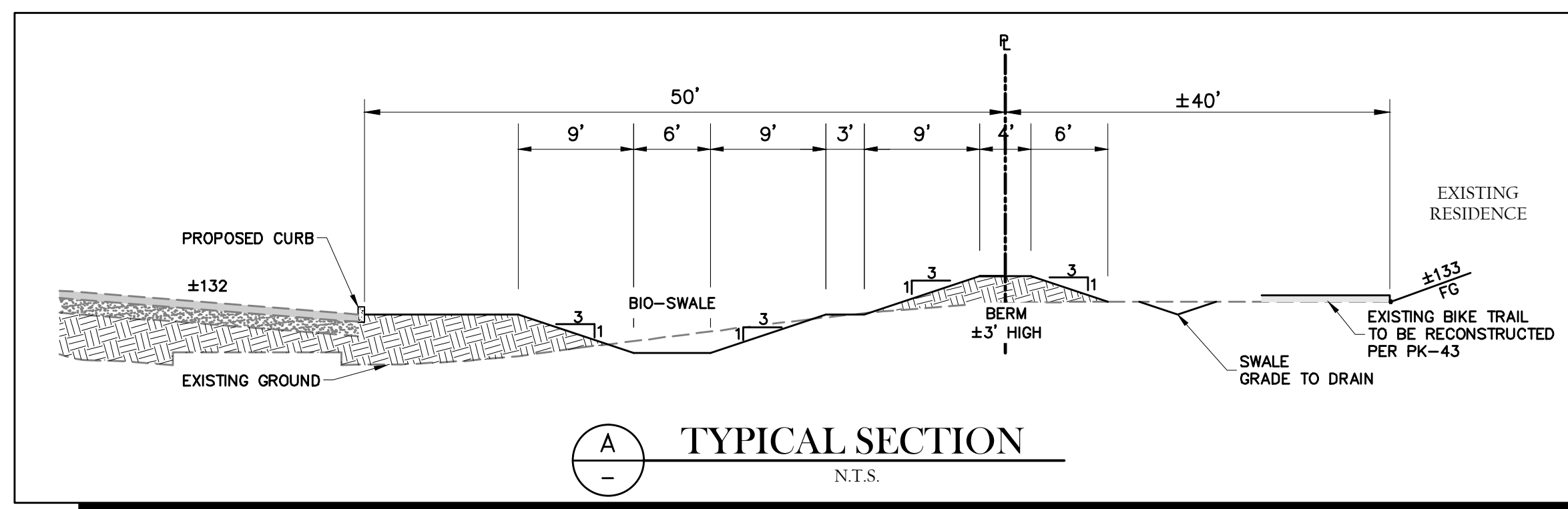
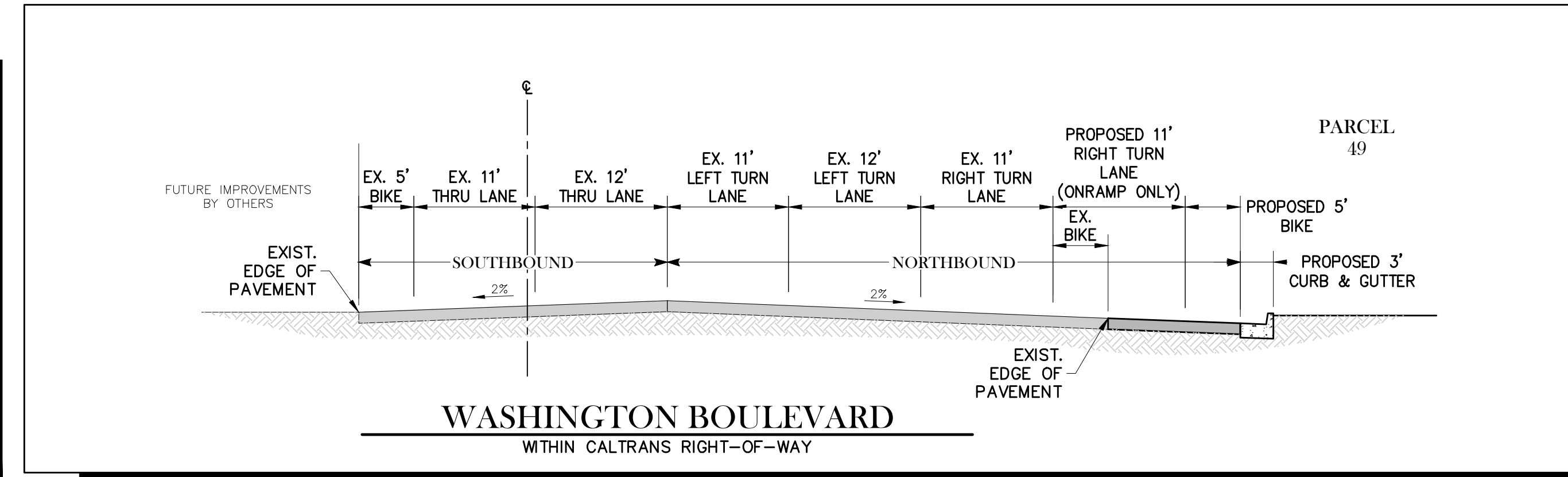
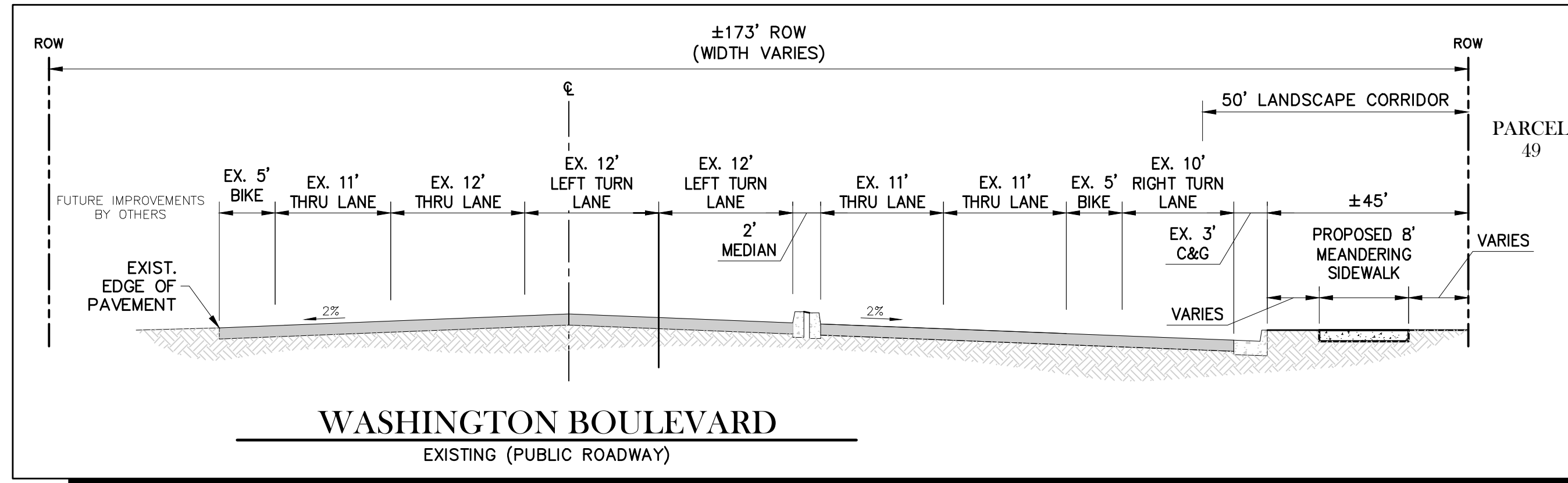
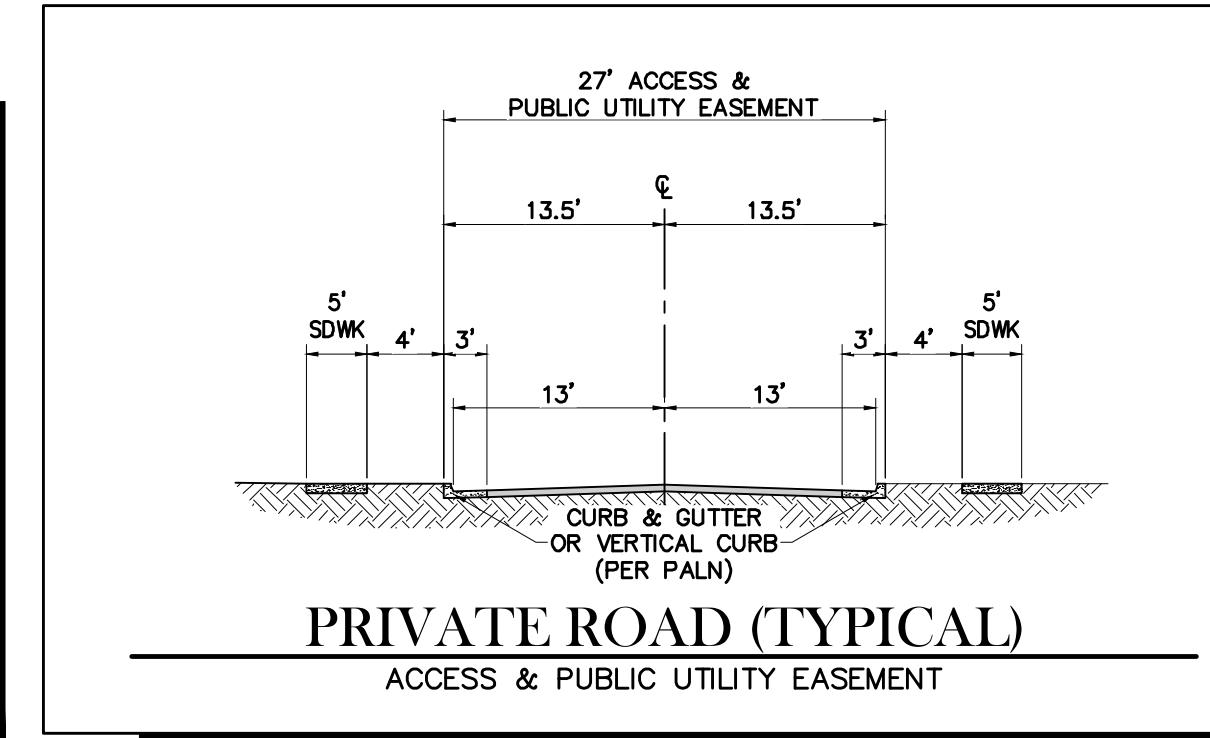
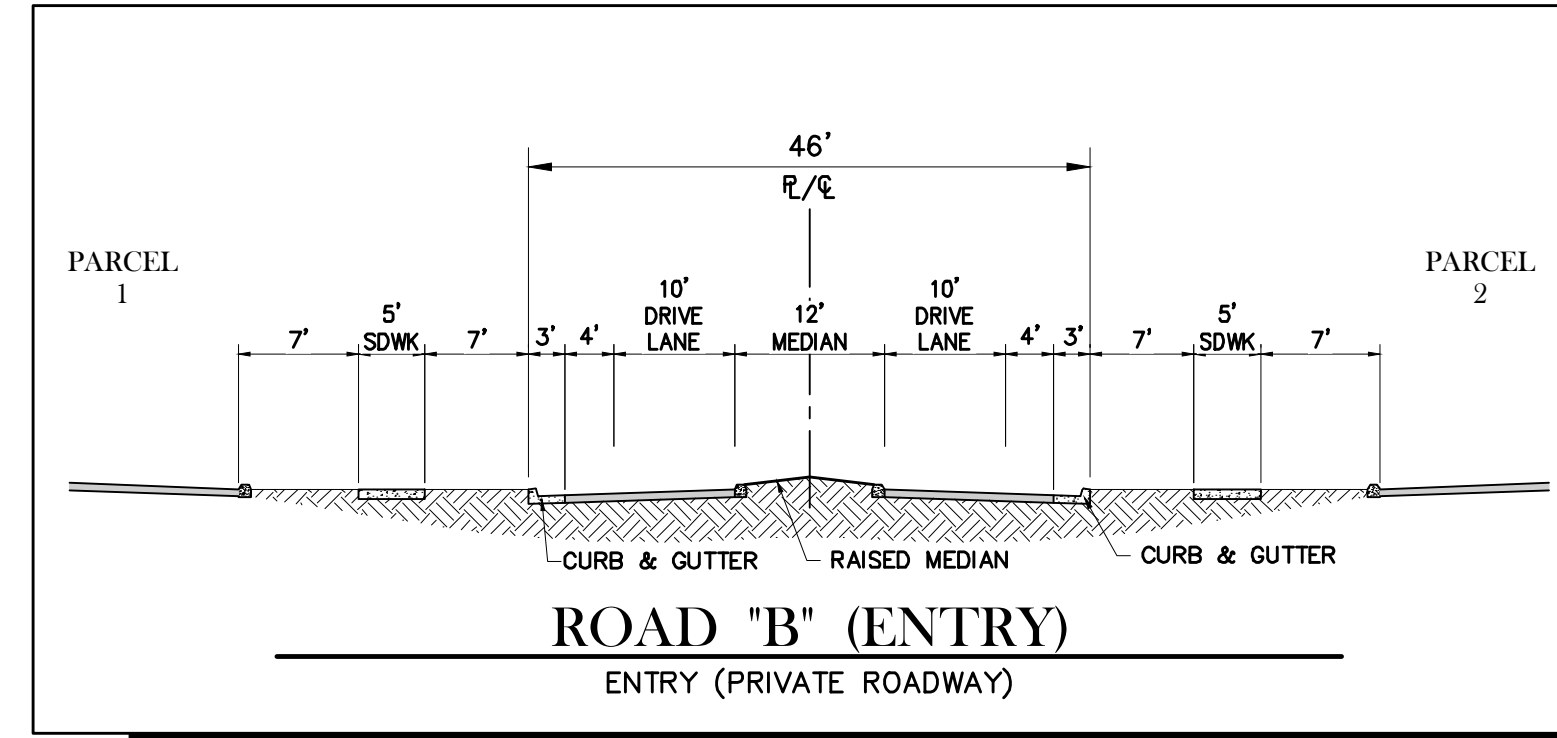
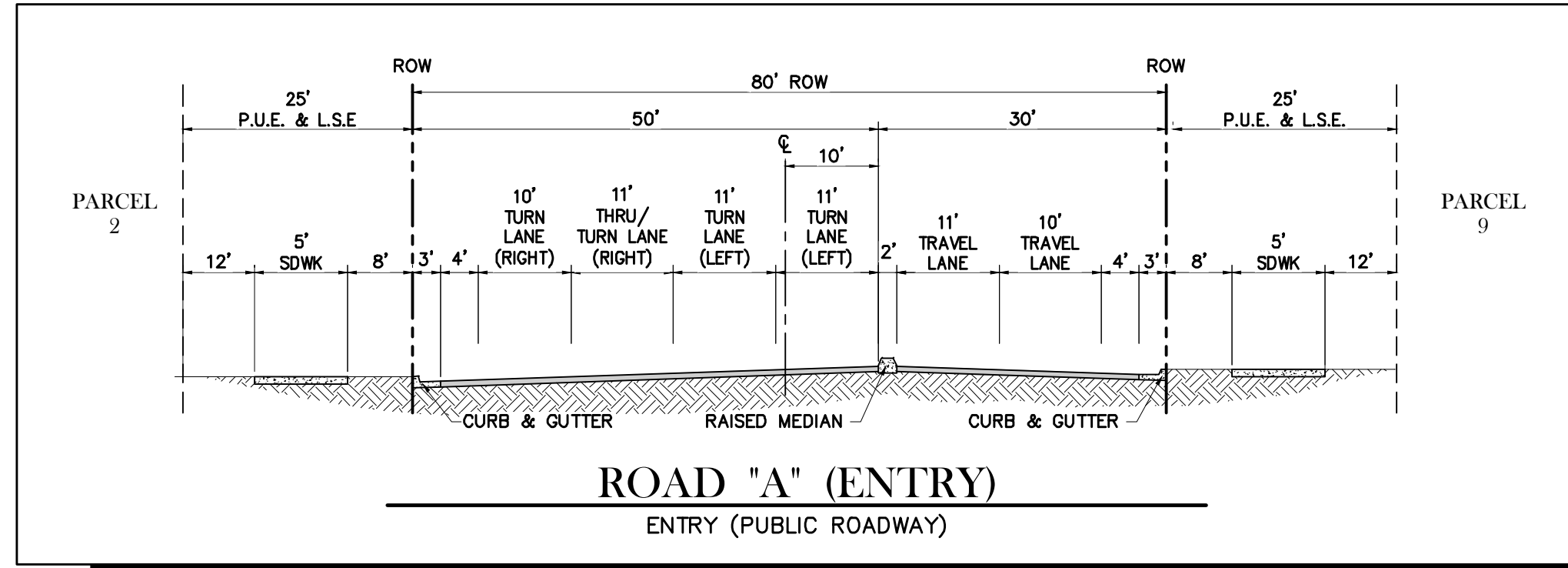

MAJOR PROJECT PERMIT - STAGE 1
 PRELIMINARY SECTIONS
 DECEMBER 04, 2014

TSD ENGINEERING, INC.
 expect more.
 31 Natoma Street, Suite #160
 Folsom, CA 95630
 Phone: (916) 608-0707
 Fax: (916) 608-0701

SHEET
 1 OF 1

P:\Projects\308-001\02 DWG\B- Planning\Y16\Preliminary Sections.dwg, TSD-CASEY, 09/11/00, 12-03-14